

Area = 10.5M² (120ft²)

The 12ft x 10ft unit
 A Classic jackleg unit, always popular due to its tidy size and good value for money.
 Ideal for one person

©This drawing is copyright © and is the property of Masterkabin Ltd.

No part of this document may be re-produced or transmitted in any form or stored in any retrieval system of any nature without the written permission of Masterkabin Ltd

Masterkabin Ltd personnel or their agents will not be liable or responsible for any inaccuracies.

NOTES:

Layout shown for illustration purposes only

Actual units can be configured to suit any individuals requirements

Client:

Stock Unit



t. 021 4775555

f. 021 4775562

e. sales@masterkabin.ie

www.masterkabin.ie

Killountain, Innishannon, Co. Cork

Project:

12ft x 10ft(3.6m x 3m)

Drawing Title:

Proposed Plan

Drawn by:
ED

Date:
26/8/19

Scale (@ A1)

Drawing Number:
15184-06

Rev:

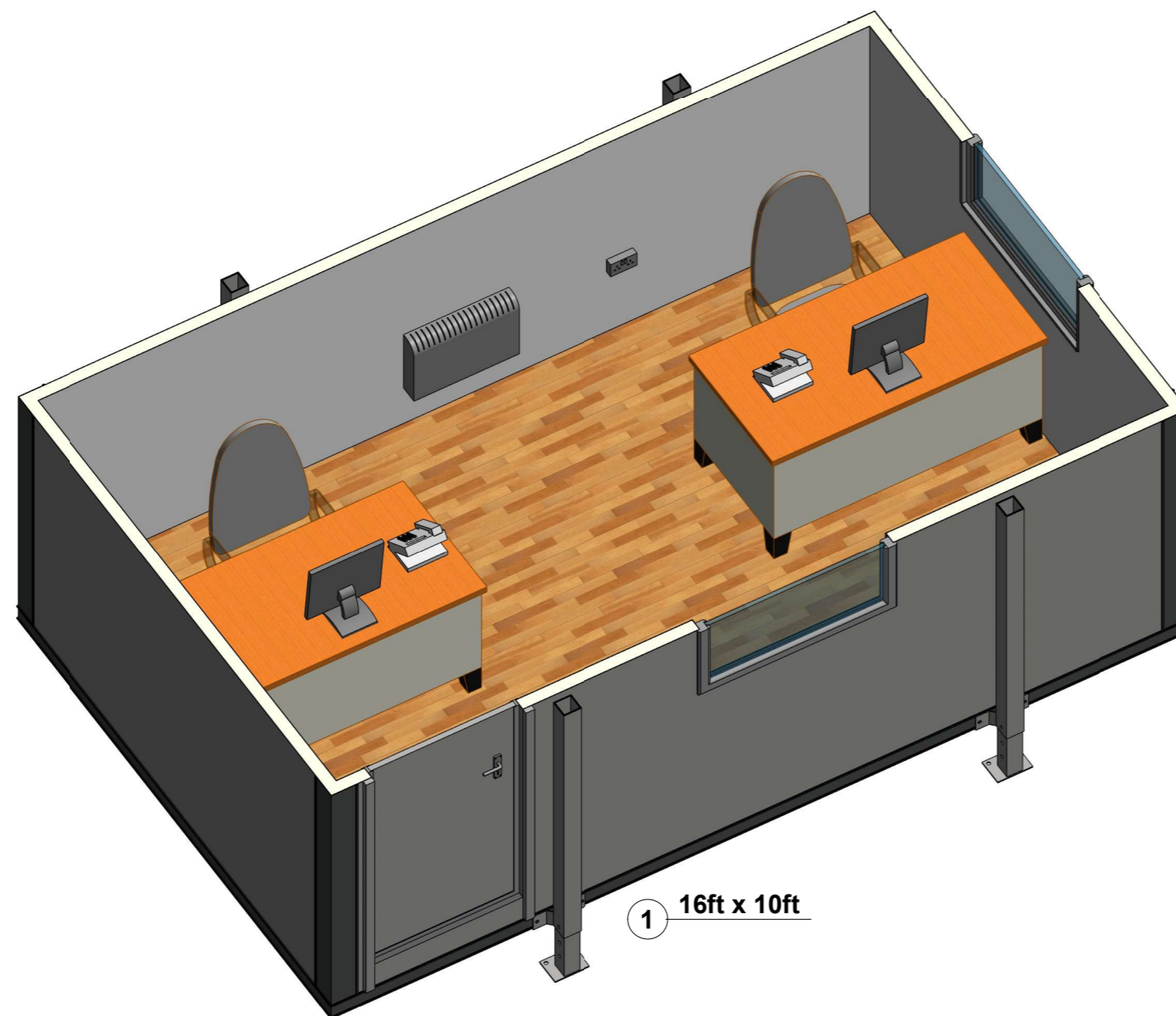

Area = 14.m² (160ft²)

The 16ft x 10ft Unit

Another popular size jackleg unit, offering similar portability as the 12ft x 10ft, but with a little extra space for a second person, or perhaps a toilet/store
Suitable for one -two people

©This drawing is copyright © and is the property of Masterkabin Ltd.

No part of this document may be re-produced or transmitted in any form or stored in any retrieval system of any nature without the written permission of Masterkabin Ltd

Masterkabin Ltd personnel or their agents will not be liable or responsible for any inaccuracies.

NOTES:

Layout shown for illustration purposes only

Actual units can be configured to suit any individuals requirements

Client:

Stock Unit



t. 021 4775555

f. 021 4775562

e. sales@masterkabin.ie

www.masterkabin.ie

Killountain, Innishannon, Co. Cork

Project:

16ft x 10ft (4.8m x 3m)

Drawing Title:

Proposed Plan

Drawn by:
ED

Date:
26/8/19

Scale (@ A1)

Drawing Number:
15184-06

Rev:

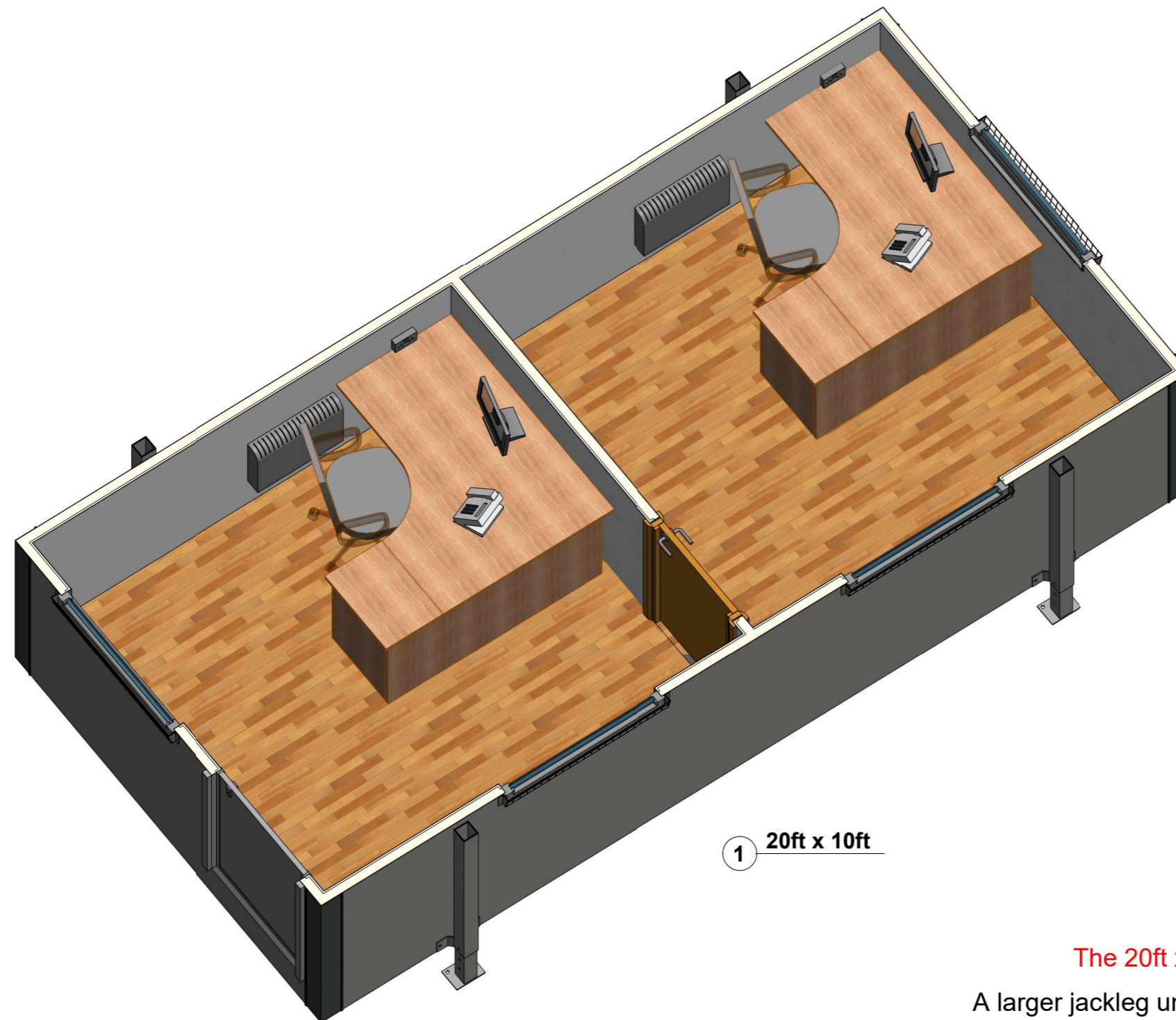

1 20ft x 10ft

Area = 17.6m² (200ft²)

The 20ft x 10ft Unit
A larger jackleg unit offering a more comfortable size for two people and large enough to divided internally if required
Suitable for two people

©This drawing is copyright © and is the property of Masterkabin Ltd.

No part of this document may be re-produced or transmitted in any form or stored in any retrieval system of any nature without the written permission of Masterkabin Ltd

Masterkabin Ltd personnel or their agents will not be liable or responsible for any inaccuracies.

NOTES:

Layout shown for illustration purposes only

Actual units can be configured to suit any individuals requirements

Client:

Stock Units



t. 021 4775555
f. 021 4775562
e. sales@masterkabin.ie
www.masterkabin.ie
Killountain, Innishannon, Co. Cork

Project:

20ft x 10ft (6m x 3m)

Drawing Title:

Proposed Plan

Drawn by:
ED

Date:
26/8/19

Scale (@ A1)

Drawing Number:
15184-06

Rev:

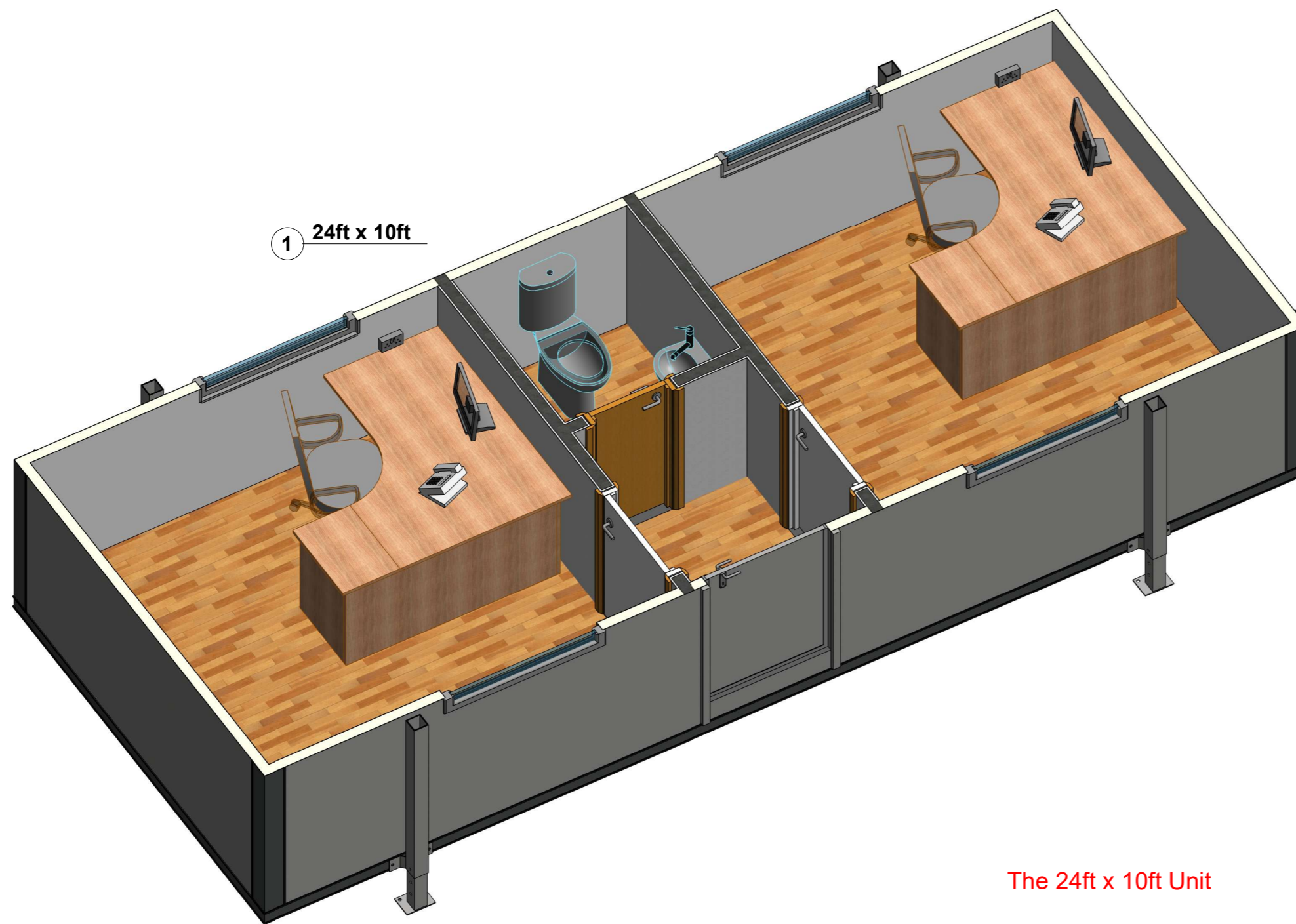

Area = 21.9.m² (236ft²)

The 24ft x 10ft Unit

A larger jackleg unit, offering a more comfortable size for two or even three people and large enough to further divide internally if required

Suitable for two -four people

©This drawing is copyright © and is the property of Masterkabin Ltd.

No part of this document may be re-produced or transmitted in any form or stored in any retrieval system of any nature without the written permission of Masterkabin Ltd

Masterkabin Ltd personnel or their agents will not be liable or responsible for any inaccuracies.

NOTES:

Layout shown for illustration purposes only

Actual units can be configured to suit any individuals requirements

Client:

Stock Unit



t. 021 4775555

f. 021 4775562

e. sales@masterkabin.ie

www.masterkabin.ie

Killlountain, Innishannon, Co. Cork

Project:

24ft x 10ft (7.2m x3m)

Drawing Title:

Proposed Plan

Drawn by:
ED

Date:
26/8/19

Scale (@ A1)

Drawing Number:
15184-06

Rev:

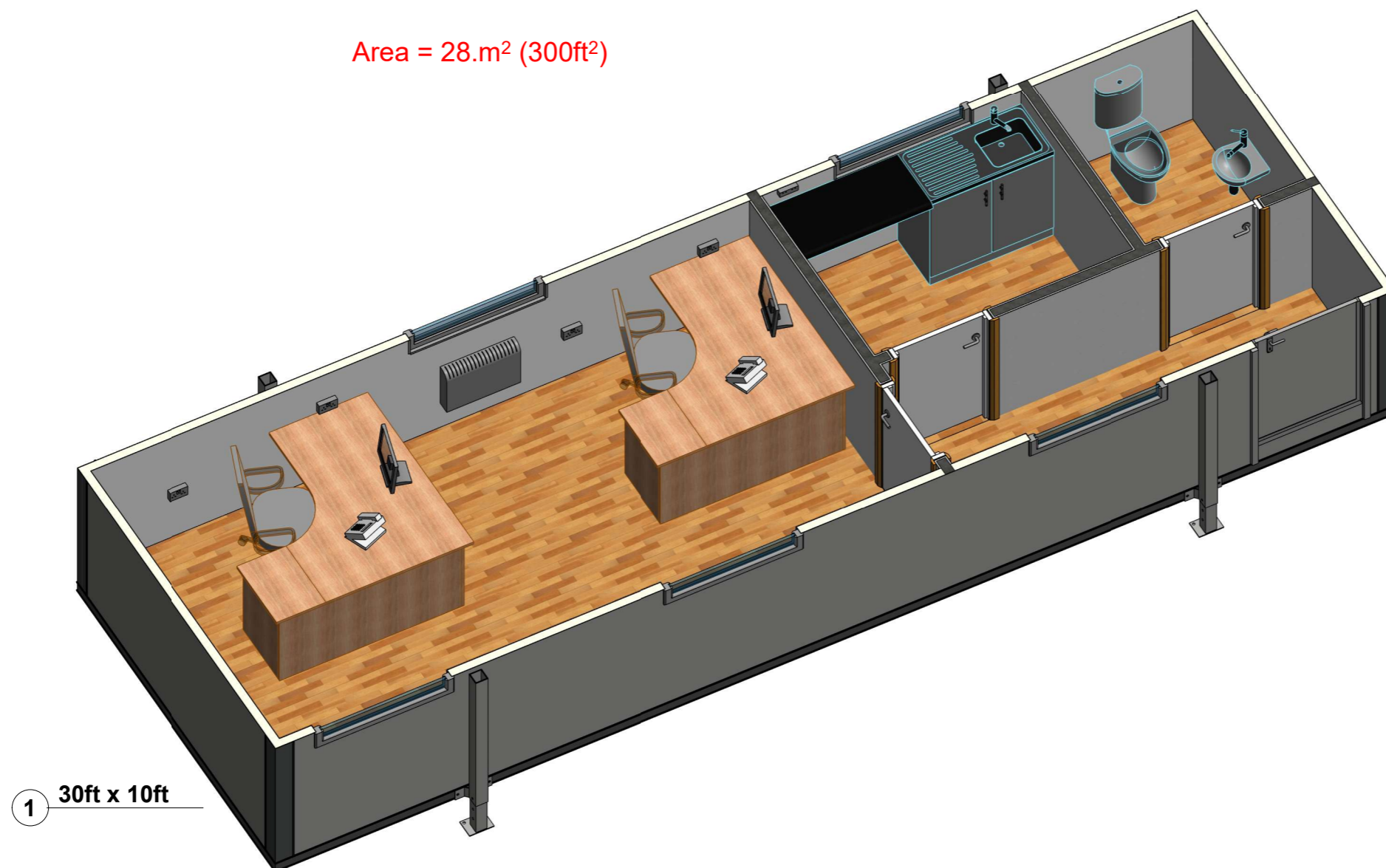

Area = 28.m² (300ft²)

The 30ft x 10ft Unit

Is a fairly long unit, which requires more space on site. However the extra length offers great scope for adding toilets, kitchenettes etc. to the layout if required
Suitable for two -six people

©This drawing is copyright © and is the property of Masterkabin Ltd.

No part of this document may be re-produced or transmitted in any form or stored in any retrieval system of any nature without the written permission of Masterkabin Ltd

Masterkabin Ltd personnel or their agents will not be liable or responsible for any inaccuracies.

NOTES:

Layout shown for illustration purposes only

Actual units can be configured to suit any individuals requirements

Client:

Stock Unit



t. 021 4775555
f. 021 4775562
e. sales@masterkabin.ie
www.masterkabin.ie
Killountain, Innishannon, Co. Cork

Project:

30ft x 10ft (9M x 3M)

Drawing Title:

Proposed Plan

Drawn by:
ED

Date:
28/8/19

Scale (@ A1)

Drawing Number:
15184-06

Rev:

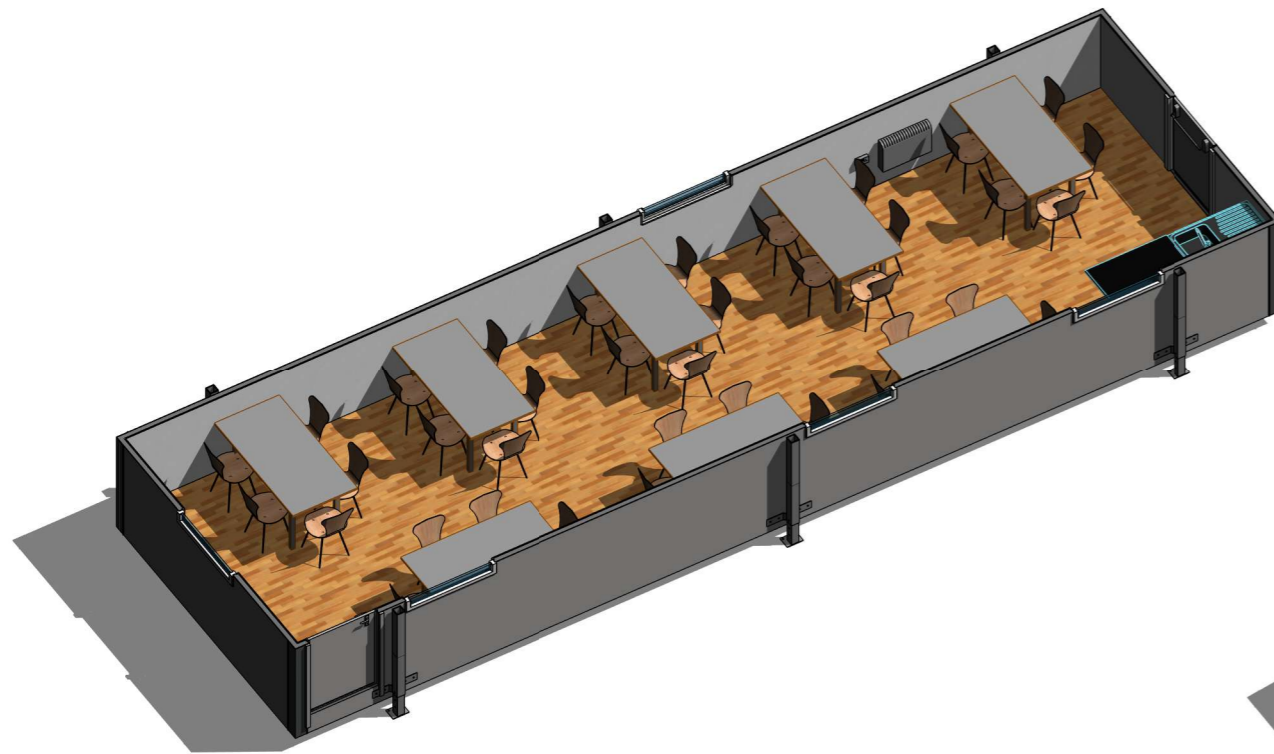

Area = 43.7.5M² (480ft²)

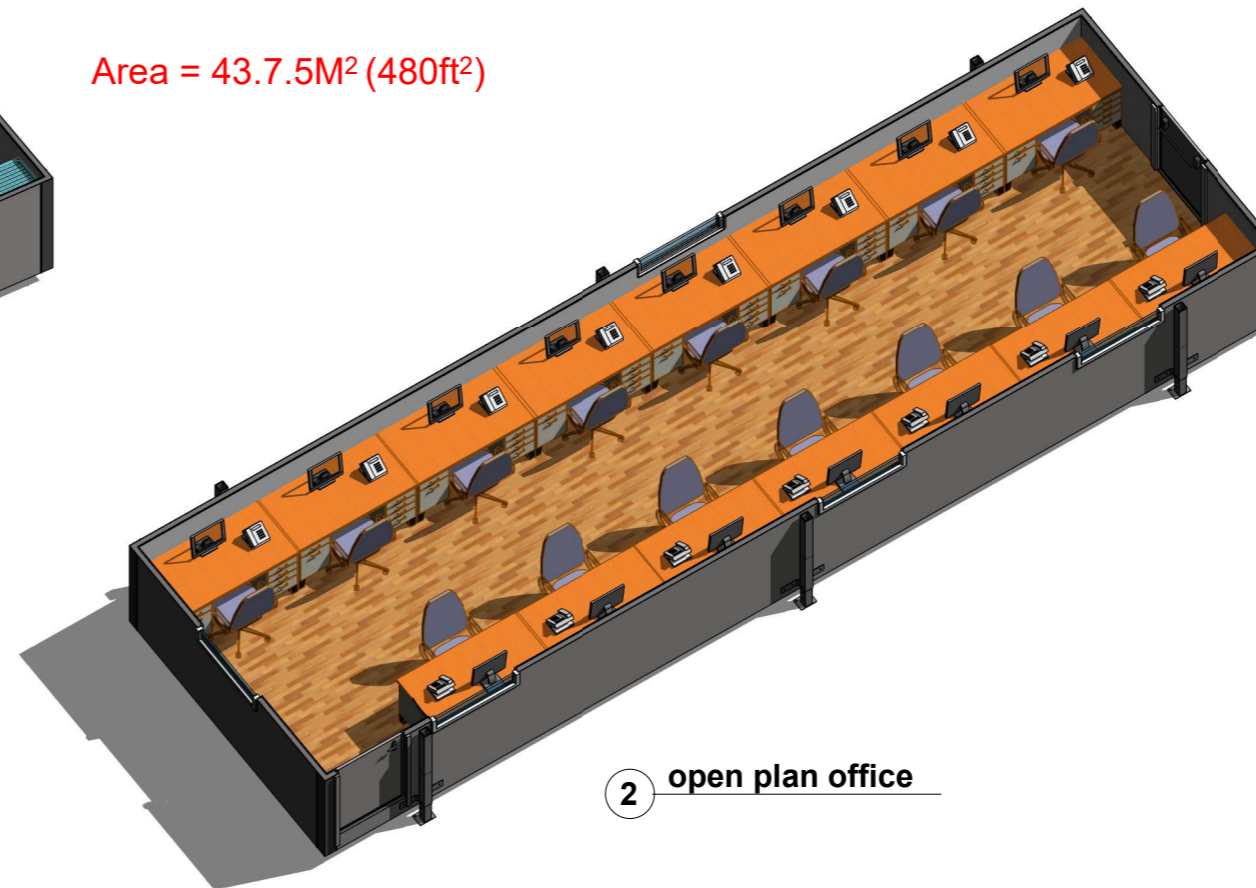

1 Canteen

2 open plan office

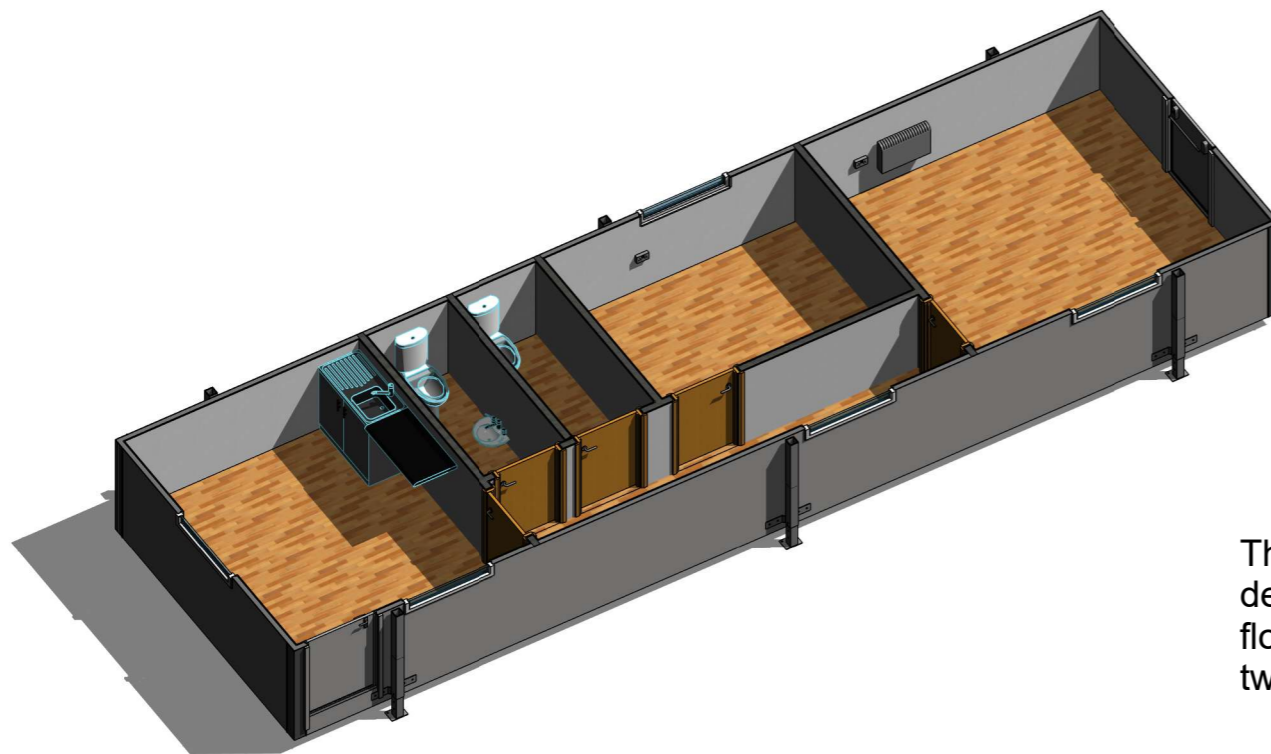

The 40ft x 12ft unit

The largest standard jackleg unit. Requires more planning for delivery, craneage, wide load permits etc. but offers an unrivaled amount of floor area in a self contained and ready to occupy unit. The additional two feet in the width brings enormous sense of space
Suitable for eight to thirty five people

3 40ft x 12ft layout option option 1

©This drawing is copyright © and is the property of Masterkabin Ltd.

No part of this document may be re-produced or transmitted in any form or stored in any retrieval system of any nature without the written permission of Masterkabin Ltd

Masterkabin Ltd personnel or their agents will not be liable or responsible for any inaccuracies.

NOTES:

Layout shown for illustration purposes only

Actual units can be configured to suit any individuals requirements

Client:

Stock Unit



t. 021 4775555
f. 021 4775562
e. sales@masterkabin.ie
www.masterkabin.ie
Killountain, Innishannon, Co. Cork

Project:

40ft x 12ft (12.2m x 3.6m)

Drawing Title:

Proposed Plan

Drawn by:
ED

Date:
28/8/19

Scale (@ A1)

Drawing Number:
15184-06

Rev: